



Bulk Asbestos Analysis

(EPA Method 600/R-93-116, Visual Area Estimation)

Chico Unified School Dist
Leroy Christophersen

2455 Carmichael Drive
Chico, CA 95928

Client ID: 2921
Report Number: B099242
Date Received: 05/17/07
Date Analyzed: 05/21/07
Date Printed: 05/21/07
First Reported: 05/21/07

Job ID/Site: Chapman Elementary School - PO# 070280

FASI Job ID: 2921

Date(s) Collected: 05/16/2007

Total Samples Submitted: 3

Total Samples Analyzed: 3

Sample ID	Lab Number	Asbestos Type	Percent in Layer	Asbestos Type	Percent in Layer	Asbestos Type	Percent in Layer
CH01	10641701						
Layer: Grey Plaster			ND				
Layer: Paint			ND				
Total Composite Values of Fibrous Components:		Asbestos (ND)					
Cellulose (Trace)							
CH02	10641702						
Layer: Grey Plaster			ND				
Layer: Paint			ND				
Total Composite Values of Fibrous Components:		Asbestos (ND)					
Cellulose (Trace)							
CH03	10641703						
Layer: Grey Plaster			ND				
Layer: Paint			ND				
Total Composite Values of Fibrous Components:		Asbestos (ND)					
Cellulose (Trace)							

James Flores, Laboratory Supervisor, Hayward Laboratory

Note: Limit of Quantification ('LOQ') = 1%. 'Trace' denotes the presence of asbestos below the LOQ. 'ND' = 'None Detected'.

Analytical results and reports are generated by Forensic Analytical at the request of and for the exclusive use of the person or entity (client) named on such report. Results, reports or copies of same will not be released by Forensic Analytical to any third party without prior written request from client. This report applies only to the sample(s) tested. Supporting laboratory documentation is available upon request. This report must not be reproduced except in full, unless approved by Forensic Analytical. The client is solely responsible for the use and interpretation of test results and reports requested from Forensic Analytical. This report must not be used by the client to claim product endorsement by NVLAP or any other agency of the U.S. Government. Forensic Analytical is not able to assess the degree of hazard resulting from materials analyzed. Forensic Analytical reserves the right to dispose of all samples after a period of thirty (30) days, according to all state and federal guidelines, unless otherwise specified. All samples were received in acceptable condition unless otherwise noted.



Forensic Analytical

Analysis Request Form

Client Name & Address: Chico Unified School District 2455 Carmichael Drive Chico, CA 95928		P.O. #: 070280 Date: 5/16/07
Contact: Leroy Christophersen Phone #: 530-891-3195 Fax#: 1christo@mail.chico.usd.org (530) 891-3190 Site: CHAPMAN Job:		Turn Around Time: ___ hr/ 12hr / 24hr / <u>48 hr</u> ext: ___ Due Date: ___ / ___ / ___ Due Time: ___ : ___ am/pm <input checked="" type="checkbox"/> PLM: <input checked="" type="checkbox"/> Standard / <input type="checkbox"/> Point Count <input type="checkbox"/> PCM: NIOSH 7400 <input type="checkbox"/> TEM Air: <input type="checkbox"/> AHERA / <input type="checkbox"/> Yamate2 / <input type="checkbox"/> NIOSH 7402 <input type="checkbox"/> TEM Bulk: <input type="checkbox"/> Quantitative / <input type="checkbox"/> Qualitative / <input type="checkbox"/> Chatfield <input type="checkbox"/> TEM Water: <input type="checkbox"/> Potable / <input type="checkbox"/> Non-Potable / <input type="checkbox"/> Wt % <input type="checkbox"/> TEM Microvac <input type="checkbox"/> Special Project: <input type="checkbox"/> Metals Analysis: Method _____ Matrix: _____ Analytes: _____

Comments: Point Count is "Trace" results

Sample ID	Date/Time	Sample Location/Description	FOR AIR SAMPLES ONLY				Sample Area or Air Volume
			Type	Time On/Off	Avg. LPM	Total Time	
CH01	5/16	Principal office dry wall	A P C				
CH02	5/16	Halway dry wall	A P C				
CH03	5/16	Principal office dry wall.	A P C				
			A P C				
			A P C				
			A P C				
			A P C				
			A P C				
			A P C				

Sampled by: Leroy Date: 5/16/07 Time: 10:00 AM
Shipped via: ☐ Fed Ex ☐ Airborne ☐ UPS ☐ US Mail ☐ Courier ☐ Drop Off ☐ Other:

Relinquished by: Date / Time:	Relinquished by: Date / Time:	Relinquished by: Date / Time:
Received by: Date / Time: RECEIVED MAY 17 2007	Received by: Date / Time:	Received by: Date / Time:
Condition Acceptable? <input type="checkbox"/> Yes <input checked="" type="checkbox"/> No	Condition Acceptable? <input type="checkbox"/> Yes <input type="checkbox"/> No	Condition Acceptable? <input type="checkbox"/> Yes <input type="checkbox"/> No

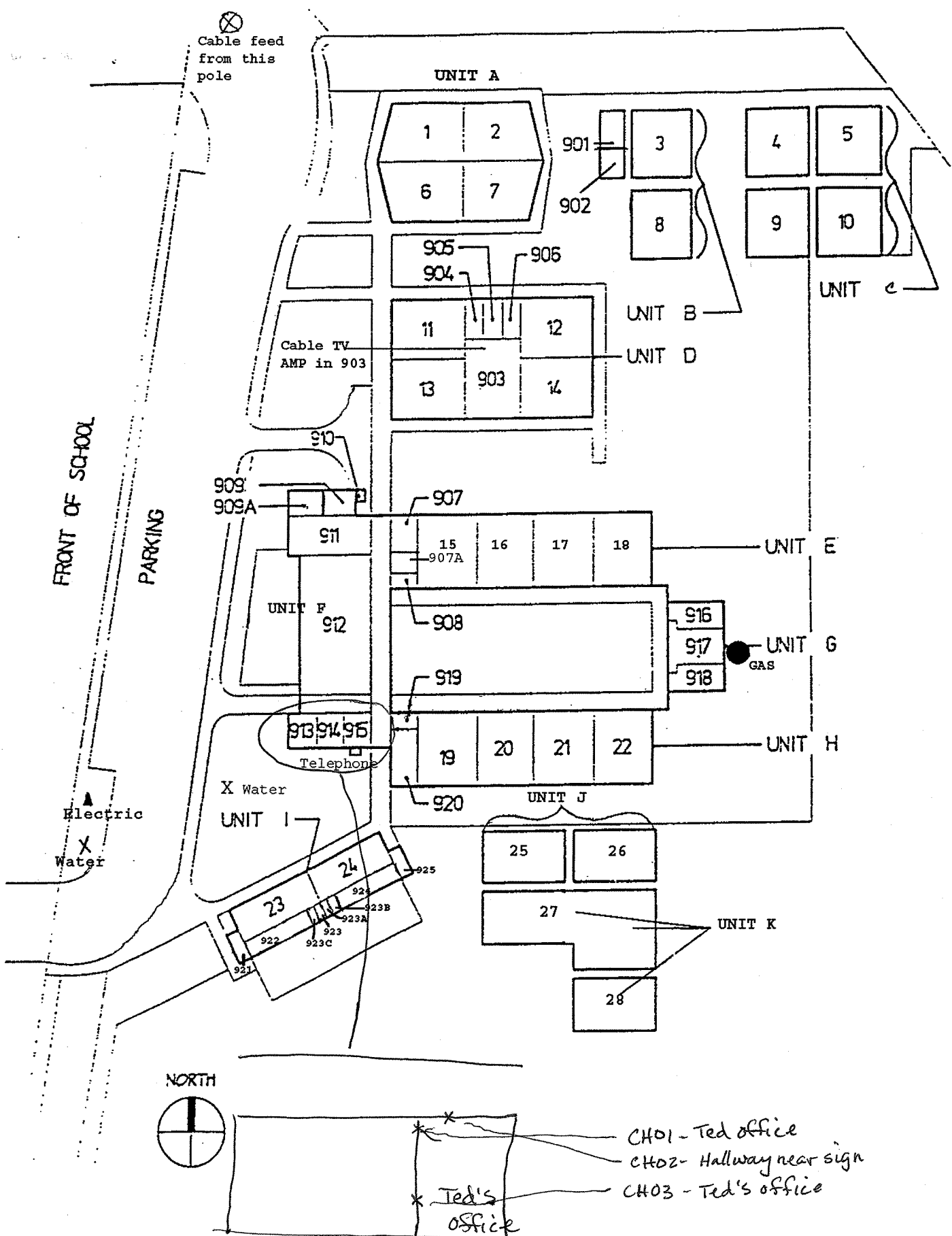

CHAPMAN ELEMENTARY SCHOOL

Updated 9/2006

Maintenance and Operations
2455 Carmichael Drive
Chico, CA 95928
Phone: (530) 891-3195
Fax: (530) 891-3190

Chico Unified School District

Fed Ex Airbill #8358 1795 1216

May 16, 2007

Forensic Analytical Specialties, Inc.
3777 Depot Road, Suite 409
Hayward, CA 94545

Re: Chapman Elementary School

To Whom It May Concern:

Please test the enclosed samples from Chapman Elementary School Administration for Asbestos. We would like a 48-hour turnaround on the samples. Please e-mail the results as soon as they are available to lchristo@chicousd.org.

Site Sampled:	Chapman Elementary School
Location:	Administration
Date Sampled:	May 16, 2007
Number of Samples:	(Three)#CH01 – Principal's Office Drywall #CH02 – Hallway Drywall #CH03 – Principal's Office Drywall

Thank you for your prompt response to this request.

Sincerely,



Leroy Christophersen
Safety & Loss Coordinator

Enclosures (3)
dlg

SIX MONTH SURVEILLANCE HOMOGENEOUS ACBM RECORDS

Date of Inspection: 12/26/07

District: Chico Unified School District

Inspector: Leroy Christophersen

School: Chapman Elementary School

Building: Unit A (FKA G)

Material Class	Material	Homo. Mat. #	% Asb.	Ft ² /L.F.	Location	Condition: Code & Comments	Friable Yes/No
T	MUD JOINT	1	1-5%	UNDETERMINED	THROUGHOUT	(1) (4) SAMPLE HMS-CPM-03 COLLECTED ON 4/9/88.	Y
M	TRANSITE PANELS	2	ASSUMED	UNDETERMINED	THROUGHOUT	(11) COULD NOT LOCATE.	N
M	12" VFT CREAM	3	None Detectedb	400 S	CLASSROOMS 1, 2, 6, & 7	(13) CUSD sample taken 12/26/07 chp01-chp 04	N

School: Chapman Elementary School

Building: Unit D (FKA F)

Material Class	Material	Homo. Mat. #	% Asb.	Ft ² /L.F.	Location	Condition: Code & Comments	Friable Yes/No
M	9" VFT	4	1-5%	UNDETERMINED	THROUGHOUT EXCEPT IN LIBRARY	(1) (4)	N/A
M	9" VFT	5	1-5%	UNDETERMINED	THROUGHOUT EXCEPT IN LIBRARY	(1) (4)	N/A
M	TRANSITE PANELS	6	ASSUMED	400 S	EXTERIOR	(1) (4)	N

CONDITION CODE

General Condition: (1) Good (2) Damaged (3) Significantly Damaged (25% or more)

Change in Condition: (4) No (5) Yes (If Yes, explain under comments)

Abated: (6) Repaired (7) Removed (8) Encapsulated (9) Enclosed (10) Isolated & Restricted

Miscellaneous: (11) Inaccessible, no inspection data (12) Other (Explain under comments) (13) Non-Asbestos/Not Inspected

CONSULT ORIGINAL AND SUPPLEMENTARY INSPECTION REPORTS FOR MATERIALS WITH TRACE AMOUNTS OF ASBESTOS

**SIX MONTH SURVEILLANCE
HOMOGENEOUS ACBM RECORDS**

Date of Inspection: 12/26/07

District: Chico Unified School District

Inspector: Leroy Christophersen

School: Chapman Elementary School

Building: Unit E (FKA C)

Material Class	Material	Homo. Mat. #	% Asb.	Ft ² /L.F.	Location	Condition: Code & Comments	Friable Yes/No
M	TRANSITE PANELS	7	ASSUMED	400 S	EXTERIOR	(1) (4)	N
M	12" VFT CREAM	8	None Detected	3,600 S	CLASSROOMS 15-18	(13) CUSD sample 12/26/07 chp 01-04	N

School: Chapman Elementary School

Building: Unit F (FKA A)

Material Class	Material	Homo. Mat. #	% Asb.	Ft ² /L.F.	Location	Condition: Code & Comments	Friable Yes/No
M	9" VFT BROWN	9	10-15%	UNDETERMINED	KITCHEN	(1)	N
M	12" VFT CREAM	10	None Detected	3,600 S	MPR, CORRIDOR, AND OFFICES	(13) CUSD sample on 12/26/07 chp 01-04	N
M	12" ACT	11	ASSUMED	3,600 S	MPR, CORRIDOR, AND OFFICES	(1)	N
S	PLASTER	12	NONE DETECTED	UNDETERMINED	KITCHEN	(13)	N/A

CONDITION CODE

General Condition: (1) Good (2) Damaged (3) Significantly Damaged (25% or more)

Change in Condition: (4) No (5) Yes (If Yes, explain under comments)

Abated: (6) Repaired (7) Removed (8) Encapsulated (9) Enclosed (10) Isolated & Restricted

Miscellaneous: (11) Inaccessible, no inspection data (12) Other (Explain under comments) (13) Non-Asbestos/Not Inspected

CONSULT ORIGINAL AND SUPPLEMENTARY INSPECTION REPORTS FOR MATERIALS WITH TRACE AMOUNTS OF ASBESTOS

**SIX MONTH SURVEILLANCE
HOMOGENEOUS ACBM RECORDS**

Date of Inspection: 12/26/07

District: Chico Unified School District

Inspector: Leroy Christophersen

School: Chapman Elementary School

Building: Unit H (FKA B)

Material Class	Material	Homo. Mat. #	% Asb.	Ft ² /L.F.	Location	Condition: Code & Comments	Friable Yes/No
M	TRANSITE PANELS	13	ASSUMED	400 S	EXTERIOR	(1) (4)	N
M	12" VFT cream	14	None Detected	3,600 S	CLASSROOMS 19-22	(13) CUSD sample on 12/26/07 chp 01- chp 04	N

CONDITION CODE

General Condition: (1) Good (2) Damaged (3) Significantly Damaged (25% or more)

Change in Condition: (4) No (5) Yes (If Yes, explain under comments)

Abated: (6) Repaired (7) Removed (8) Encapsulated (9) Enclosed (10) Isolated & Restricted

Miscellaneous: (11) Inaccessible, no inspection data (12) Other (Explain under comments) (13) Non-Asbestos/Not Inspected

CONSULT ORIGINAL AND SUPPLEMENTARY INSPECTION REPORTS FOR MATERIALS WITH TRACE AMOUNTS OF ASBESTOS



Bulk Asbestos Analysis

(EPA Method 600/R-93-116, Visual Area Estimation)

Chico Unified School Dist
Leroy Christophersen

2455 Carmichael Drive
Chico, CA 95928

Client ID: 2921
Report Number: B104006
Date Received: 09/19/07
Date Analyzed: 09/21/07
Date Printed: 09/21/07
First Reported: 09/21/07

Job ID/Site: Chapman - Re-roof - PO#070280

Date(s) Collected: 09/14/2007

FAJI Job ID: 2921
Total Samples Submitted: 14
Total Samples Analyzed: 14

Sample ID	Lab Number	Asbestos Type	Percent in Layer	Asbestos Type	Percent in Layer	Asbestos Type	Percent in Layer
CHP01	10681949						
Layer: Black Tar			ND				
Layer: Black Felt			ND				
Layer: Black Tar			ND				
Layer: Black Felt			ND				
Layer: Black Tar			ND				
Layer: Black Felt			ND				
Layer: Black Tar			ND				
Layer: Black Felt			ND				

Total Composite Values of Fibrous Components: Asbestos (ND)

Cellulose (Trace) Fibrous Glass (45 %)

Comment: Bulk complex sample.

CHP02	10681950						
Layer: Black Tar			ND				
Layer: Black Felt			ND				
Layer: Black Tar			ND				
Layer: Black Felt			ND				
Layer: Black Tar			ND				
Layer: Black Felt			ND				

Total Composite Values of Fibrous Components: Asbestos (ND)

Cellulose (Trace) Fibrous Glass (45 %)

Comment: Bulk complex sample.

CHP03	10681951						
Layer: Black Tar			ND				
Layer: Black Felt			ND				
Layer: Black Tar			ND				
Layer: Black Felt			ND				
Layer: Black Tar			ND				
Layer: Black Felt			ND				

Total Composite Values of Fibrous Components: Asbestos (ND)

Cellulose (Trace) Fibrous Glass (45 %)

Comment: Bulk complex sample.

Name: Chico Unified School Dist

Report Number: B104006

Date Printed: 09/21/07

Sample ID	Lab Number	Asbestos Type	Percent in Layer	Asbestos Type	Percent in Layer	Asbestos Type	Percent in Layer
CHP04	10681952						
Layer: Black Tar			ND				
Layer: Black Felt			ND				
Layer: Black Tar			ND				
Layer: Black Felt			ND				
Layer: Black Tar			ND				
Layer: Black Felt			ND				
Layer: Black Tar			ND				
Layer: Black Felt			ND				

Total Composite Values of Fibrous Components: Asbestos (ND)

Cellulose (Trace) Fibrous Glass (45 %)

Comment: Bulk complex sample.

CHP05	10681953						
Layer: Black Tar			ND				
Layer: Black Felt			ND				
Layer: Black Tar			ND				
Layer: Black Felt			ND				
Layer: Black Tar			ND				
Layer: Black Felt			ND				
Layer: Black Tar			ND				
Layer: Black Felt			ND				

Total Composite Values of Fibrous Components: Asbestos (ND)

Cellulose (Trace) Fibrous Glass (45 %)

Comment: Bulk complex sample.

CHP06	10681954						
Layer: Black Tar			ND				
Layer: Black Felt			ND				
Layer: Black Tar			ND				
Layer: Black Felt			ND				
Layer: Black Tar			ND				
Layer: Black Felt			ND				

Total Composite Values of Fibrous Components: Asbestos (ND)

Cellulose (Trace) Fibrous Glass (45 %)

Comment: Bulk complex sample.

Name: Chico Unified School Dist

Report Number: B104006

Date Printed: 09/21/07

Sample ID	Lab Number	Asbestos Type	Percent in Layer	Asbestos Type	Percent in Layer	Asbestos Type	Percent in Layer
CHP07	10681955						
Layer: Black Tar			ND				
Layer: Black Felt			ND				
Layer: Black Tar			ND				
Layer: Black Felt			ND				
Layer: Black Tar			ND				
Layer: Black Felt			ND				
Layer: Black Tar			ND				
Layer: Black Felt			ND				
Layer: Black Tar			ND				
Layer: Black Felt			ND				
Layer: Black Tar			ND				
Layer: Black Felt			ND				
Layer: Black Tar			ND				
Layer: Black Felt			ND				

Total Composite Values of Fibrous Components: Asbestos (ND)

Cellulose (Trace) Fibrous Glass (50 %)

Comment: Bulk complex sample.

CHP08	10681956						
Layer: Black Tar			ND				
Layer: Black Felt			ND				
Layer: Black Tar			ND				
Layer: Black Felt			ND				
Layer: Black Tar			ND				
Layer: Black Felt			ND				
Layer: Black Tar			ND				
Layer: Black Felt			ND				

Total Composite Values of Fibrous Components: Asbestos (ND)

Cellulose (Trace) Fibrous Glass (45 %)

Comment: Bulk complex sample.

CHP09	10681957						
Layer: Black Tar			ND				
Layer: Black Felt			ND				
Layer: Black Tar			ND				
Layer: Black Felt			ND				
Layer: Black Tar			ND				
Layer: Black Felt			ND				
Layer: Black Tar			ND				
Layer: Black Felt			ND				

Total Composite Values of Fibrous Components: Asbestos (ND)

Cellulose (Trace) Fibrous Glass (45 %)

Comment: Bulk complex sample.

Name: Chico Unified School Dist

Report Number: B104006

Date Printed: 09/21/07

Sample ID	Lab Number	Asbestos Type	Percent in Layer	Asbestos Type	Percent in Layer	Asbestos Type	Percent in Layer
CHP10	10681958						
Layer: Black Tar			ND				
Layer: Black Felt			ND				
Layer: Black Tar			ND				
Layer: Black Felt			ND				
Layer: Black Tar			ND				
Layer: Black Felt			ND				

Total Composite Values of Fibrous Components: Asbestos (ND)

Cellulose (Trace) Fibrous Glass (45 %)

Comment: Bulk complex sample.

CHP11	10681959						
Layer: Black Tar			ND				
Layer: Black Felt			ND				
Layer: Black Tar			ND				
Layer: Black Felt			ND				
Layer: Black Tar			ND				
Layer: Black Felt			ND				
Layer: Black Tar			ND				
Layer: Black Felt			ND				
Layer: Black Tar			ND				
Layer: Black Felt			ND				

Total Composite Values of Fibrous Components: Asbestos (ND)

Cellulose (Trace) Fibrous Glass (45 %)

Comment: Bulk complex sample.

CHP12	10681960						
Layer: Black Tar			ND				
Layer: Black Felt			ND				
Layer: Black Tar			ND				
Layer: Black Felt			ND				
Layer: Black Tar			ND				
Layer: Black Felt			ND				

Total Composite Values of Fibrous Components: Asbestos (ND)

Cellulose (Trace) Fibrous Glass (45 %)

Comment: Bulk complex sample.

Name: Chico Unified School Dist

Report Number: B104006

Date Printed: 09/21/07

Sample ID	Lab Number	Asbestos Type	Percent in Layer	Asbestos Type	Percent in Layer	Asbestos Type	Percent in Layer
CHP13	10681961						
Layer: Black Tar			ND				
Layer: Black Felt			ND				
Layer: Black Tar			ND				
Layer: Black Felt			ND				
Layer: Black Tar			ND				
Layer: Black Felt			ND				
Layer: Black Tar			ND				
Layer: Black Felt			ND				
Layer: Black Tar			ND				
Layer: Black Felt			ND				

Total Composite Values of Fibrous Components: Asbestos (ND)

Cellulose (Trace) Fibrous Glass (45 %)

Comment: Bulk complex sample.

CHP14	10681962						
Layer: Black Tar			ND				
Layer: Black Felt			ND				
Layer: Black Tar			ND				
Layer: Black Felt			ND				
Layer: Black Tar			ND				
Layer: Black Felt			ND				
Layer: Black Tar			ND				
Layer: Black Felt			ND				

Total Composite Values of Fibrous Components: Asbestos (ND)

Cellulose (Trace) Fibrous Glass (45 %)

Comment: Bulk complex sample.



James Flores, Laboratory Supervisor, Hayward Laboratory

Note: Limit of Quantification ('LOQ') = 1%. 'Trace' denotes the presence of asbestos below the LOQ. 'ND' = 'None Detected'.

Analytical results and reports are generated by Forensic Analytical at the request of and for the exclusive use of the person or entity (client) named on such report. Results, or copies of same will not be released by Forensic Analytical to any third party without prior written request from client. This report applies only to the sample(s) supporting laboratory documentation is available upon request. This report must not be reproduced except in full, unless approved by Forensic Analytical. The client is solely responsible for the use and interpretation of test results and reports requested from Forensic Analytical. This report must not be used by the client to claim product endorsement by NVLAP or any other agency of the U.S. Government. Forensic Analytical is not able to assess the degree of hazard resulting from materials analyzed. Forensic Analytical reserves the right to dispose of all samples after a period of thirty (30) days, according to all state and federal guidelines, unless otherwise specified. All samples were received in acceptable condition unless otherwise noted.



Forensic Analytical

Analysis Request Form

Client Name & Address: Chico Unified School District 2455 Carmichael Drive Chico, CA 95928		P.O. #: 070280 Date: 9/18/07
Contact: Leroy Christophersen Phone #: 530-891-3195 Fax#: (530) 891-3190		Turn Around Time: _____ hr / 12hr / 24hr / <u>48 hr</u> / ext: _____ Due Date: / / Due Time: : am/pm <input checked="" type="checkbox"/> PLM: <input checked="" type="checkbox"/> Standard / <input type="checkbox"/> Point Count <input type="checkbox"/> PCM: NIOSH 7400 <input type="checkbox"/> TEM Air: <input type="checkbox"/> AHERA / <input type="checkbox"/> Yamate2 / <input type="checkbox"/> NIOSH 7402 <input type="checkbox"/> TEM Bulk: <input type="checkbox"/> Quantitative / <input type="checkbox"/> Qualitative / <input type="checkbox"/> Chatfield <input type="checkbox"/> TEM Water: <input type="checkbox"/> Potable / <input type="checkbox"/> Non-Potable / <input type="checkbox"/> Wt % <input type="checkbox"/> TEM Microvac <input type="checkbox"/> Special Project:
Site: <u>Chapman</u> Job: <u>Re-roof</u>		<input type="checkbox"/> Metals Analysis: Method _____ Matrix: _____ Analytes: _____
Comments:		

Sample ID	Date/Time	Sample Location/Description	FOR AIR SAMPLES ONLY				Sample Area or Air Volume
			Type	Time On/Off	Avg. LPM	Total Time	
CHP01	9/14/07	Unit E roof	A P C				
CHP02	9/14/07	Unit E roof	A P C				
CHP03			A P C				
CHP04			A P C				
CHP05			A P C				
CHP06			A P C				
CHP07			A P C				
CHP08		Unit H roof	A P C				
CHP09			A P C				

Sampled by: <u>Leroy Christophersen</u> Date: <u>9/18/07</u> Time: _____	
Shipped via: <input type="checkbox"/> Fed Ex <input type="checkbox"/> Airborne <input type="checkbox"/> UPS <input type="checkbox"/> US Mail <input type="checkbox"/> Courier <input type="checkbox"/> Drop Off <input type="checkbox"/> Other: _____	
Relinquished by: Date / Time: Received by: <u>[Signature]</u> Date / Time: Condition Acceptable? <input type="checkbox"/> Yes <input checked="" type="checkbox"/> No	Relinquished by: Date / Time: Received by: Date / Time: Condition Acceptable? <input type="checkbox"/> Yes <input type="checkbox"/> No
Relinquished by: Date / Time: Received by: Date / Time: Condition Acceptable? <input type="checkbox"/> Yes <input type="checkbox"/> No	Relinquished by: Date / Time: Received by: Date / Time: Condition Acceptable? <input type="checkbox"/> Yes <input type="checkbox"/> No



Forensic Analytical

Analysis Request Form

Client Name & Address: Chico Unified School District 2455 Carmichael Drive Chico, CA 95928		P.O. #: 070280 Date: 9/18/07
Contact: Leroy Christophersen Phone #: 530-891-3195 Fax#: (530) 891-3190		Turn Around Time: _____ hr/ 12hr / 24hr / <u>48 hr</u> / ext: _____ Due Date: / / Due Time: : am/pm <input checked="" type="checkbox"/> PLM: <input checked="" type="checkbox"/> Standard / <input type="checkbox"/> Point Count <input type="checkbox"/> PCM: NIOSH 7400
Site: <u>Chapman</u> Job: <u>Re roof</u>		<input type="checkbox"/> TEM Air: <input type="checkbox"/> AHERA / <input type="checkbox"/> Yamate2 / <input type="checkbox"/> NIOSH 7402 <input type="checkbox"/> TEM Bulk: <input type="checkbox"/> Quantitative / <input type="checkbox"/> Qualitative / <input type="checkbox"/> Chatfield <input type="checkbox"/> TEM Water: <input type="checkbox"/> Potable / <input type="checkbox"/> Non-Potable / <input type="checkbox"/> Wt % <input type="checkbox"/> TEM Microvac <input type="checkbox"/> Special Project: <input type="checkbox"/> Metals Analysis: Method _____ Matrix: _____ Analytes: _____

Comments:

Sample ID	Date/Time	Sample Location/Description	FOR AIR SAMPLES ONLY				Sample Area or Air Volume
			Type	Time On/Off	Avg. LPM	Total Time	
CHP10	9/18/07	Unit H roof	A P C				
CHP11			A P C				
CHP12			A P C				
CHP13			A P C				
CHP14			A P C				
			A P C				
			A P C				
			A P C				
			A P C				

Sampled by: <u>Leroy Christophersen</u> Date: <u>9/18/07</u> Time: _____	
Shipped via: <input type="checkbox"/> Fed Ex <input type="checkbox"/> Airborne <input type="checkbox"/> UPS <input type="checkbox"/> US Mail <input type="checkbox"/> Courier <input type="checkbox"/> Drop Off <input type="checkbox"/> Other: _____	
Relinquished by: Date / Time:	Relinquished by: Date / Time:
Received by: <u>[Signature]</u> Date / Time: <u>RECEIVED SEP 19 2007</u>	Received by: Date / Time:
Condition Acceptable? <input checked="" type="checkbox"/> Yes <input type="checkbox"/> No	Condition Acceptable? <input type="checkbox"/> Yes <input type="checkbox"/> No

San Francisco Office: 3777 Depot Road, Suite 409, Hayward, California 94545 / Telephone: (510)887-8828 (800)827-FASI / Fax: (510)887-4218

Los Angeles Office: 2959 Pacific Commerce Drive, Rancho Dominguez, California 90221 / Telephone: (310)763-2374 / Fax: (310)763-8684

Portland Office: 17400 SW Upper Boones Ferry Road, Suite 245, Durham, Oregon 97224 / Telephone: (503)595-1001 (877)410-1888 / Fax: (503)595-1006

Las Vegas Office: 3900 Paradise Road, Suite 181, Las Vegas, Nevada 89109 / Telephone: (702)784-0040 / Fax: (702)784-0030

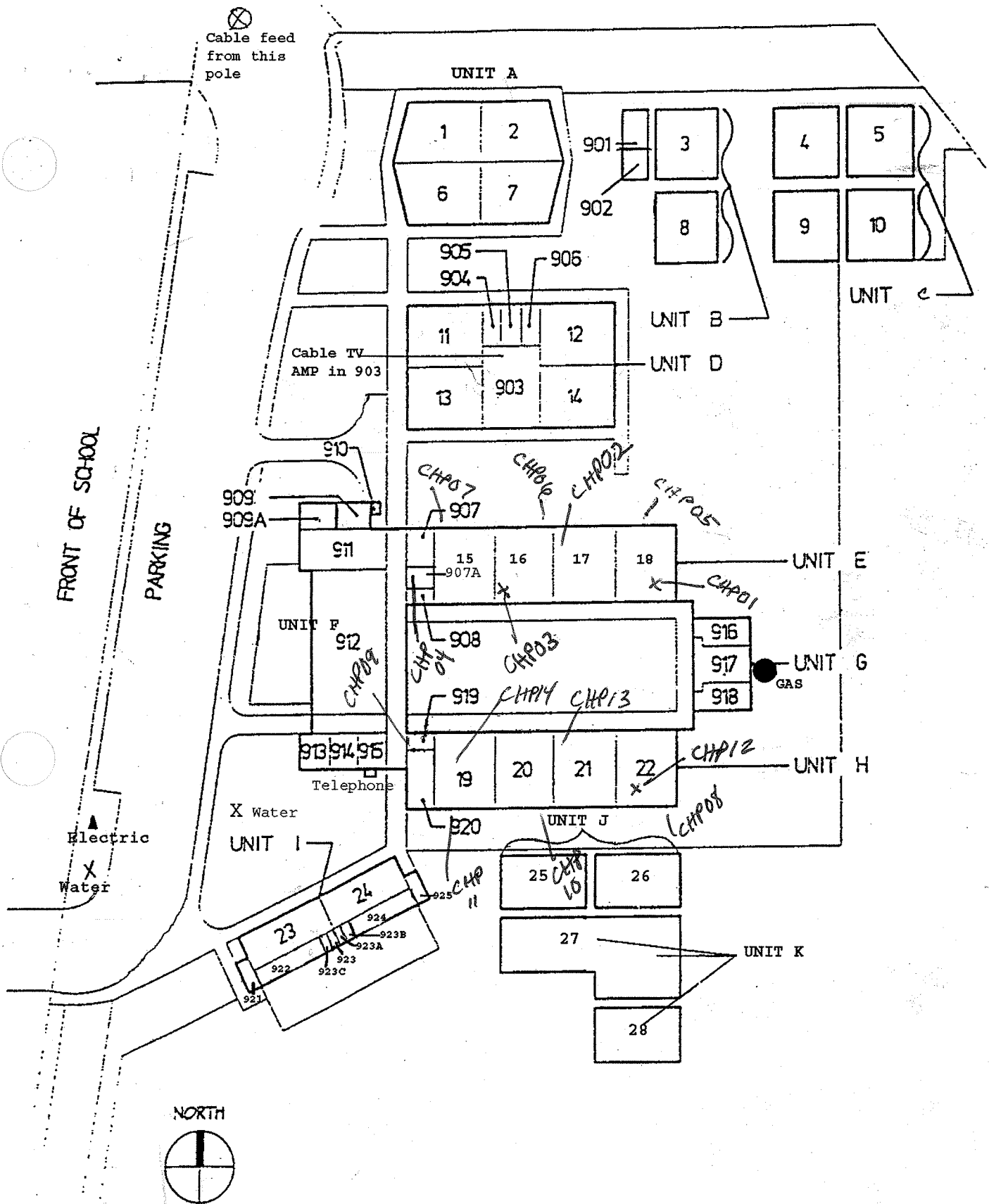

CHAPMAN ELEMENTARY SCHOOL

Updated 9/2006

Maintenance and Operations
2455 Carmichael Drive
Chico, CA 95928
Phone: (530) 891-3195
Fax: (530) 891-3190

Chico Unified School District

September 18, 2007

Fed Ex Airbill #8527 7025 2166

Forensic Analytical Specialties, Inc.
3777 Depot Road, Suite 409
Hayward, CA 94545

Re: Chapman Elementary School

To Whom It May Concern:

Please test the enclosed samples from the Chapman Elementary School Unit E & Unit H Roofs for asbestos. We would like a 48-hour turnaround on the samples. Please fax the results to us as soon as soon as they are available. Our fax number is (530) 891-3190.

Site Sampled:	Chapman Elementary School
Location:	Unit E Roof
Date Sampled:	September 14, 2007
Number of Samples:	Seven (7) - #CHP01, CHP02, CHP03, CHP04 CHP05, CHP06, CHP07
Location:	Unit H Roof
Date Sampled:	September 14, 2007
Number of Samples:	Seven (7) - #CHP08, CHP09, CHP10, CHP11 CHP12, CHP13, CHP14

Thank you for your prompt response to this request.

Sincerely,



Leroy Christophersen
Safety & Loss Control Coordinator

LC:dlg

Enclosures: (14 Samples)